

A FLANSCHAUSFÜHRUNG

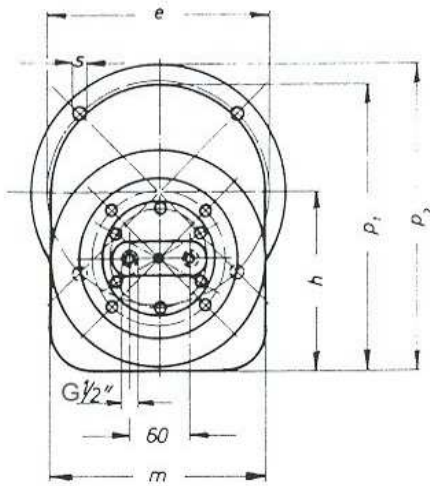

Zentrierung nach DIN 332 Blatt 2

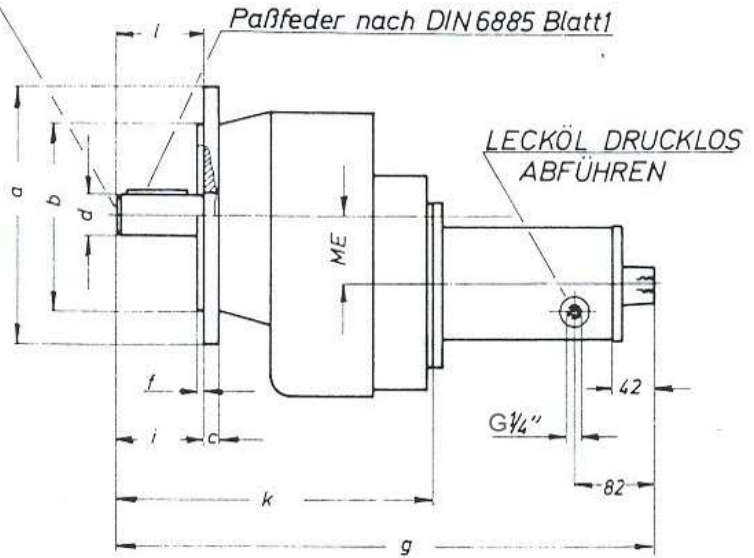

| | | | | | | | | | | | | | | | | | |
|----------|----------|-----|-------------------|----|------------------|-----|---|-----|-----|-----|-----|-----|-----|----------------|----------------|----|----|
| 600 | HM4-HM 7 | 300 | 230 _{js} | 20 | 65 _{ms} | 265 | 4 | 699 | 275 | 130 | 479 | 130 | 300 | 425 | 425 | 14 | 86 |
| 500 | HM4-HM 7 | 250 | 180 _{js} | 16 | 50 _{ks} | 215 | 4 | 610 | 245 | 100 | 390 | 100 | 250 | 370 | 370 | 14 | 86 |
| 330 | HM4-HM 7 | 250 | 180 _{js} | 16 | 40 _{ks} | 215 | 4 | 524 | 173 | 80 | 304 | 80 | 200 | 273 | 298 | 14 | 65 |
| Getriebe | Motoren | a | b | c | d | e | f | g | h | i | k | l | m | p ₁ | p ₂ | s | ME |

Untersetzungen und Drehmomente
siehe Blatt SK 3.3

Bestellbeispiel HM 7 - 60,4 | 330

Hydromotor Getriebe

Gewicht ca.

Typ 600+Motor=163,2 kg

Typ 500+Motor=86,2 kg

Typ 330+Motor=41,2 kg

B FUSSAUSFÜHRUNG

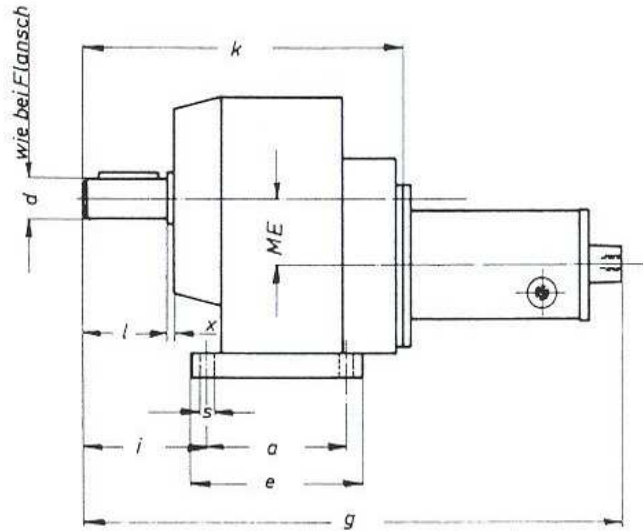
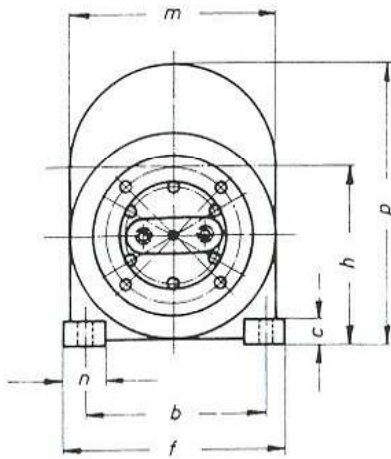

| | | | | | | | | | | | | | | | | | |
|----------|---------|-----|-----|----|-----|-----|-----|-----|-----|-----|-----|-----|----|-----|----|---|----|
| 600 | HM4-HM7 | 240 | 325 | 45 | 300 | 400 | 699 | 280 | 169 | 479 | 130 | 300 | 70 | 430 | 22 | 4 | 86 |
| 500 | HM4-HM7 | 190 | 260 | 35 | 230 | 314 | 610 | 250 | 134 | 390 | 100 | 250 | 60 | 375 | 18 | 4 | 86 |
| 330 | HM4-HM7 | 134 | 175 | 25 | 165 | 215 | 524 | 175 | 120 | 304 | 80 | 200 | 40 | 275 | 13 | 3 | 65 |
| Getriebe | Motoren | a | b | c | e | f | g | h | i | k | l | m | n | p | s | x | ME |

HYDRO - GETRIEBEMOTOREN

SK101-3.3



MW Hydraulik GmbH

Teil. 06188 - 812 91
Fax: 06188 8454

Lange Hecke 3
63796 Kahl